

SANTOS SAS:

140-150 AVENUE ROGER SALENGRO
69120 VAULX-EN-VELIN (LYON) - FRANCE
TEL. 33 (0) 472 37 35 29
Email: santos@santos.fr www.santos.fr



ESPRESSO COFFEE GRINDER NO. 67 - NO. 67GBW

OPERATING & SERVICING MANUAL



IMPORTANT: documents contained in this manual and to be kept:

- "EC" DECLARATION OF CONFORMITY
- WARRANTY CERTIFICATE

ENGLISH VERSION



Coffee grinders - Fruit presses - Mixers - Blenders - Drinks dispensers - Mixer-blenders - Dough mixers - Cheese graters - Ice crushers - Meat mincers - Vegetable cutters

REGISTERED DESIGN - FRANCE AND INTERNATIONAL
INTERNATIONALLY PATENTED MODELS

CONTENTS

"EC/EU" DECLARATION OF CONFORMITY	4
SAFETY RULES	5
<i>INSTALLATION - HANDLING</i>	<i>5</i>
<i>RESTRICTIONS.....</i>	<i>5</i>
<i>ELECTRICAL CONNECTION</i>	<i>6</i>
<i>1st USE</i>	<i>6</i>
<i>END-OF-LIFE PRODUCT RECYCLING.....</i>	<i>7</i>
PRESENTATION.....	7
Description of the appliance	7
Description of the control panel.....	8
Description of the graphics screen.....	8
USING THE APPLIANCE.....	9
<i>PREAMBLE</i>	<i>9</i>
<i>FIRST USE.....</i>	<i>9</i>
Setting the position of the fork	9
Assembly and preparation	9
Assembly and preparation	10
Setting the position of the fork	10
<i>USE.....</i>	<i>10</i>
Switching on	10
Switching off the appliance	11
<i>SELECTING A DOSE.....</i>	<i>11</i>
<i>QUICK ACCESS TO THE SETTINGS OF THE ACTIVE RECIPE</i>	<i>11</i>
<i>ACCESS TO THE MENUS.....</i>	<i>12</i>
Menu list	12
Displaying the dispensed dose counters	12
Recipe creation	12
"Pulse" function	12
Recipe activation.....	13
"Stop&Go" management(67 version).....	13
Quick modification of recipes.....	13
Management of burrs wear and history of the number of sets replaced	13
Event log.....	13
<i>SETTING THE APPLIANCE.....</i>	<i>13</i>
Step 1: Grind setting	13
Step 2: Choosing the speed of the motor	14
Step 3: Setting the dose of ground coffee (timers / weight)	14
<i>FUNCTION SPECIFIC TO THE 67GBW.....</i>	<i>15</i>
Portafilter recognition	15
Deleting the calibration of a portafilter.....	17

Deactivating the "Portafilter recognition" function	17
Deactivating the balance	17
Operation of the 67GBW in Timer mode	17
Calibration / Calibration verification of the Balance	17
STANDBY	18
CLEANING	18
Cleaning the Bean hopper	18
Cleaning the GbW Balance.....	18
Quick access to the grinding body and anti-static tab	18
Cleaning the grinding body.....	19
Cleaning of the anti-static tab	19
Cleaning the coffee outlet conduit	19
SAFETY	19
Bean hopper safety.....	19
SERVICING	19
Spare parts.....	19
Access to the inside of the appliance	19
Replacing burrs	20
Resetting the wear percentage of the burrs	21
<i>Prolonged non-use</i>	<i>21</i>
TROUBLESHOOTING ASSISTANCE	22
The appliance is not in the correct language.....	22
The appliance does not start.....	22
The appliance stops because the motor has overheated: (the motor unit is hot)	23
The appliance stops following an overload	23
The dose of ground coffee is not even	23
The appliance runs without filling the portafilter	23
- <i>67 version</i> - Espresso coffees tend to be increasingly lighter	23
- <i>67GBW version</i> - the grinder does not stop.....	23
- <i>67GBW version</i> - The dose displayed is different from the actual dose	23
- <i>67GBW version</i> - The Balance is defective.....	23
The appliance is not operating after a power failure	23
The appliance turns off automatically	24
The burrs set replacement indicator remains visible	24
TECHNICAL SPECIFICATIONS OF THE APPLIANCE	25
<i>TECHNICAL SPECIFICATIONS</i>	25
<i>Electrical diagram</i>	26
<i>Correlation table</i>	27
WARRANTY CERTIFICATE	Erreur ! Signet non défini.

"EC/EU" DECLARATION OF CONFORMITY

THE MANUFACTURER:

SANTOS SAS - 140-150, Av. Roger SALENGRO 69120 VAULX-EN-VELIN (LYON) FRANCE

Declares that the appliance to be launched on the professional market, hereinafter:

Designation: **Espresso coffee grinder**
Type Number: **67, 67GBW**

is in compliance:

- with the regulations defined by appendix 1 of the EU "Machinery" Directive **No. 2006/42/EC** and with national implementing legislation.
- with the regulatory provisions of the following European directives and regulations:
 - No. 2014/35/EU (Low Voltage Directive)
 - No. 2014/30/EU (EMC Directive)
 - No. 2011/65/EU (RoHS Directive)
 - No. 2012/19/EU (WEEE Directive)
 - No. 1935/2004/EC (Regulation) concerning materials and articles intended to come into contact with foodstuffs
 - No. 10/2011/EU (Regulation) concerning plastics intended for contact with foodstuffs

Harmonised European standards used to give presumption of conformity with the essential requirements of the directives mentioned above:

- NF EN ISO 12100:2010, Machine safety - General design principles
- EN 60204-1:2018, Machine safety – Electrical equipment of machines – General requirements
- NF EN 1672-2:2020, Food products machinery - Fundamental concepts - Hygiene requirements
- NF EN 60335-1:2013, Safety of household electrical appliances and similar appliances
- NF EN 60335-2-64:2004, Particular requirements for commercial electric kitchen machines

Issued in VAULX-EN-VELIN on: **01/03/2026**

Title of signatory: **PRESIDENT AND CHIEF EXECUTIVE OFFICER**

Name of signatory: **Aurélien FOUQUET**

Signature:



SAFETY RULES

When using, servicing or disposing of the appliance, always observe the following basic precautions.

Read the complete user manual
Keep this user manual

Note: To facilitate the understanding of the following paragraphs, refer to the diagrams at the end of this manual

INSTALLATION - HANDLING

Only one person is required for handling the appliance. For ease of use, we recommend placing the appliance on a table or work surface, so as to have the control panel in front of you (recommended height: 90 cm, to be adapted depending on the user).

RESTRICTIONS



1. The appliance is not intended for continuous operation.
2. Do not use this appliance to grind anything other than roasted coffee beans.
3. Remove all foreign bodies from the coffee beans (metal clips, stones, etc.) that can destroy the burrs.
4. - **67GBW version** - The appliance must be installed on a stable and horizontal surface, that does not transmit any vibrations from the immediate environment
5. - **67GBW version** - The appliance is not intended for use in an unstable environment (boat, aircraft, train, etc.)
6. - **67GBW version** - Do not use the appliance in an environment subject to drafts or air flows (outdoors in a shelter, facing a fan).
7. - **67GBW version** - Do not exert a force exceeding 3kg on the plate of the balance
8. To protect against the risk of electrocution, do not immerse the base in water or any other liquid.
9. The appliance must not be cleaned with a water jet or water under pressure.
10. Never touch the moving parts.
11. It is prohibited to operate the appliance on a work surface with a slope greater than 10° to the horizontal plane. The feet of the machine must always be supported on this surface.
12. Unplug the appliance before any intervention on it: cleaning, maintenance or servicing.
13. Do not use the appliance with a damaged power cord. It must be replaced with a cord equipped with a connector adapted to that of the appliance.
14. Use only original SANTOS-certified spare parts.
15. Do not connect multiple appliances to the same power outlet.
16. Do not use the appliance outdoors.
17. Do not place the appliance near, or on, a heat source.
18. This appliance is a professional appliance intended for professional use only. It is not intended for household use.
19. This appliance is not intended to be used by persons (including children less than 8 years old) with reduced physical, sensory or mental capabilities, or lack of experience

or knowledge, unless they are overseen by a person responsible for their safety, monitoring or prior instruction regarding the use of the appliance.

Children should be supervised to ensure that they do not play with the appliance.

20. This appliance is intended for collective use, e.g. in restaurant kitchens, canteens, hospitals and small commercial businesses such as bakeries, butchers, etc., but not for the continuous mass production of food.

ELECTRICAL CONNECTION

The appliance can operate over a single-phase electrical power supply:

- 100-240 V 50/60 Hz

This appliance can operate in both 50 Hz and 60 Hz without any adjustment needed

Line protection: the appliance must be connected to a standard 2-pole + earth socket. The installation must be equipped with an RCD and a fuse rated at 16A. **The appliance must be earthed.**

Check that the power plug is always accessible regardless of the installation mode.

CAUTION!



- Before connecting the appliance, check that the mains voltage matches the voltage of your appliance. Its value is indicated on the manufacturer's plate (6) under the appliance:
- If the power cable (7) is damaged, it must be replaced with a cord equipped with an IEC C13 type connector.

1st USE

Correctly clean the parts in contact with the coffee (fig. A).

- Remove the cover (1), the bean hopper (2), the grounds collector (4) and wash them with a standard household washing up liquid and non-abrasive sponge.

END-OF-LIFE PRODUCT RECYCLING



This appliance is marked with the symbol for the selective sorting of waste electrical and electronic equipment. This means that the product must be taken in hand by a selective collection system in accordance with Directive 2012/19/EU (WEEE) – Business appliances part – to be recycled or dismantled in order to reduce environmental impact.

For more information, please contact your dealer or the SANTOS company.

For disposal or recycling of the components of the appliance, please contact a specialised company or the SANTOS company

Electronic products that have not been selectively sorted are potentially hazardous to the environment.

Packaging materials must be disposed of or recycled in accordance with the regulations in force.

PRESENTATION

- The appliance allows roasted coffee to be ground and dispensed instantaneously via electronic dosing.
- The coffee grinder No. 67 is intended for bars, cafés, hotels, restaurants. It adapts to all espresso coffee machines.
- The appliance consists of a grinding unit and a base made of aluminium, a bean hopper made of transparent plastic, an electronic system that integrates motor control and the dosing.
- The appliance has 6 programs that can be configured.
- The following adjustments can be made:
 - Grind setting (from Filter, Fine, to Espresso)
 - Setting the dose of ground coffee dispensed.
 - Setting the rotation speed of the motor, "Slow grinding" "Fast"
- The appliance is intended exclusively for professional use.

Description of the appliance

The appliance is comprised of:

- a control panel (**8**),
- an adjustment nut of the fineness of the grind (**24**),
- a power cord (**7**),
- an overcurrent protector / Fuse (**20**),
- an On/Off button (**12**),
- a portafilter detection flap (**18**) (- *67 version* -),
- a precision balance (**36**) (- *67GBW version* -),

Description of the control panel

The control panel is comprised of: (fig. A)

- a screen (9),
- 3 selection buttons (10),
- a "Turn&Push" rotating selection button (11)

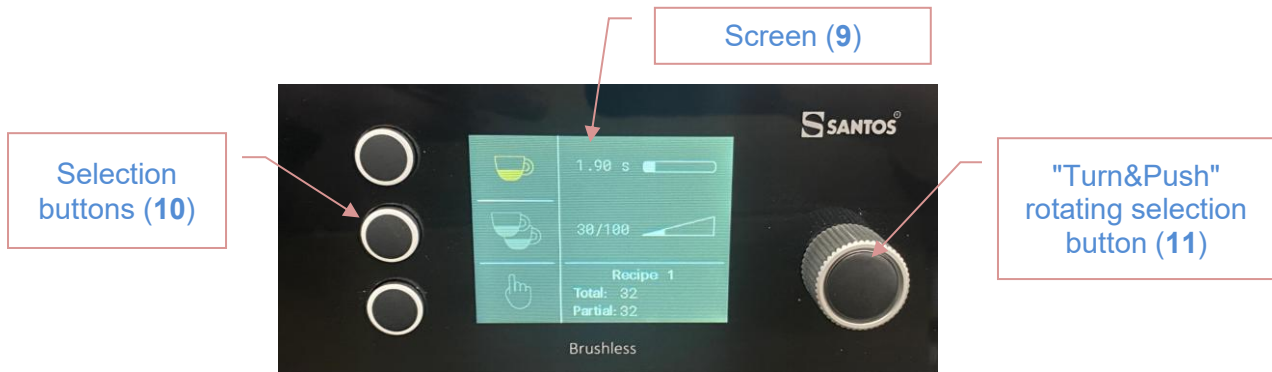

Description of the graphics screen

The screen is comprised of several zones:

- Recipe selection zone,
- Recipe parameter information zone
 - Timer
 - Motor speed
- Counter zone,
- Name of the active recipe.

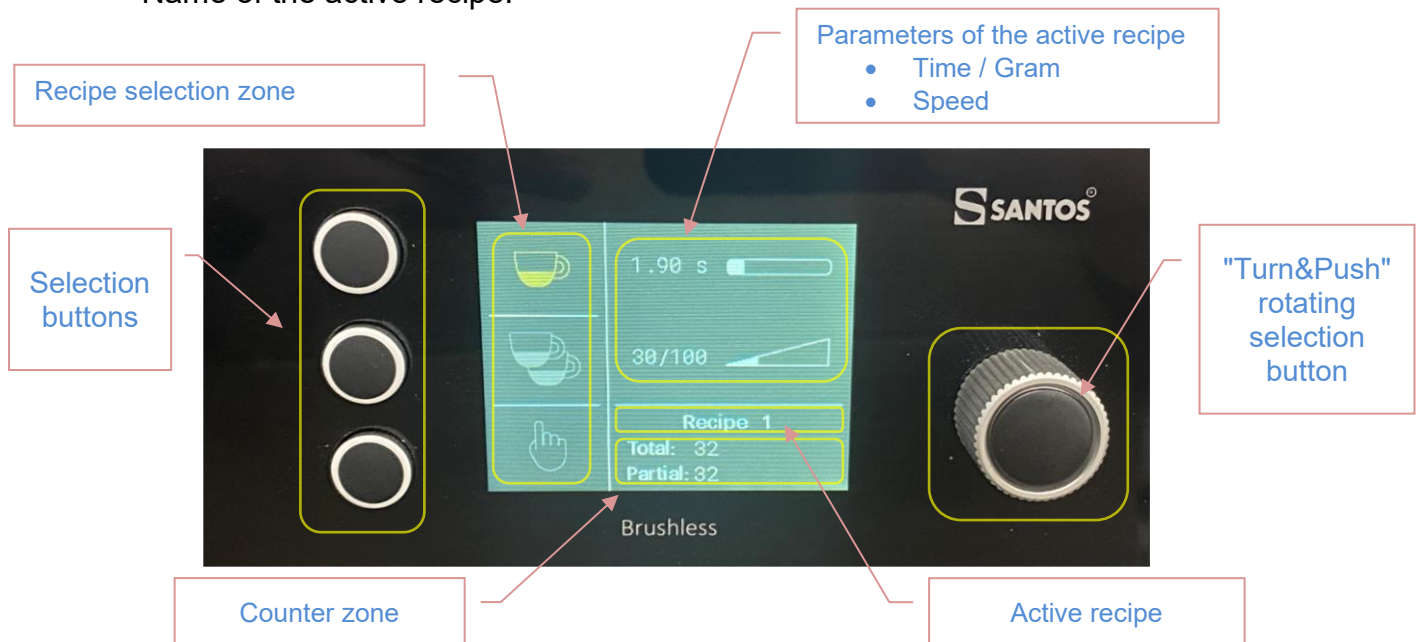

USING THE APPLIANCE

PREAMBLE



Setting a dose is carried out in 3 steps:

1. Grind setting
2. Setting the speed of the motor
3.
 - a. - *67 version* - Setting the timer,
 - b. - *67GBW version* - Weight settings

See the chapter "Setting the appliance"

FIRST USE

67GBW version



CAUTION! Carefully and delicately handle the precision balance (36). Do not press on the balance, do not exert a force exceeding 3kg

Setting the position of the fork

Unlock the retaining screw (16) of the adjustable fork (15).
Adjust the vertical position of the fork according to your portafilter



Assembly and preparation

1. **Tilt the appliance** towards the rear or lay it on its back.
2. Connect the balance cable (38) to the connector under the appliance (locking hook towards you)
3. Return the appliance to an upright position, and do not pull on the balance cable (38).



Check that the feet of the coffee grinder are properly in place between the openings of the Foot guide (37) de la balance. The balance must be able to be freely moved a few millimetres to the right and left and up and down.

GB

4. Check that balance can move freely between the feet of the appliance.
5. Connect the **power cord (7)**.
6. **Place the bean hopper (2)** on the adjustment nut of the grinding body (24).
7. **Pour the roasted coffee beans** into the bean hopper and place the cover on the bean hopper.
8. Open the shutter of the bean hopper (3).

67 version

Assembly and preparation

1. **Position the grounds collector (4)** in front of the appliance.
2. **Place the bean hopper (2)** on the adjustment nut of the grinding body (24).
3. **Pour the roasted coffee beans** into the bean hopper and place the cover on the bean hopper.
4. Open the shutter of the bean hopper (3).

Setting the position of the fork

Unlock the retaining screw (16) of the adjustable fork (15).
Adjust the vertical position of the fork according to your portafilter

USE

Switching on

1. Turn on the appliance by pressing the On/Off button (12).
2. Use the Turn&Push button (11) or the selection buttons (10) to select the recipe.
3.
 - a. - **67 version** - Place the portafilter on the fork (15) and move the detection flap (18) to deliver the dose of ground coffee.
 - b. - **67GBW version** - Place the portafilter on the fork (15), **Release** the portafilter and do not touch it again until dosing is complete
4. Remove the portafilter.



Switching off the appliance

The appliance stops automatically when dosing is complete / the recipe time has elapsed.
Or,

- By pressing the On/Off button (12).
- By removing the power cord (7) from the appliance
- By lifting up the hopper (2).

In "Stop&Go" mode,

Removing the portafilter stops the appliance (pauses the appliance).

The pause time before recipe resetting can be configured.

SELECTING A DOSE

Use one of the 3 selection buttons (10) to activate the associated recipe.

Or use the Turn&Push button (11) to display and select the other recipes.

The logo of the active recipe is yellow.

QUICK ACCESS TO THE SETTINGS OF THE ACTIVE RECIPE

On the home screen, double-clicking on the Turn&Push button (11) provides direct access to the settings of the active recipe.

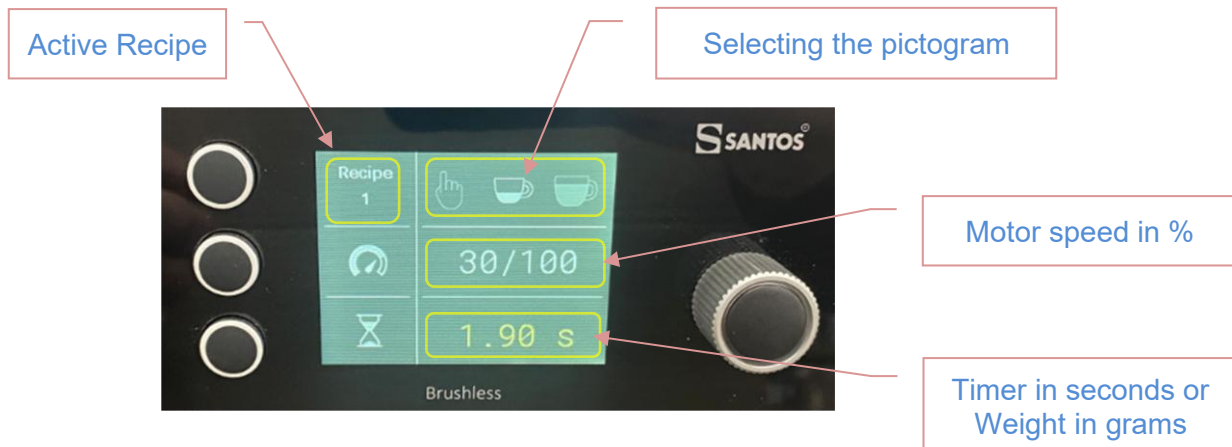

Use the rotating Turn&Push button (11) to change the value. Click on the button to record the new value.

Pressing one of the selection buttons allows you to activate the settings of the parameter of the associated line. Top button = pictogram, middle button = speed and bottom button = timer / weight in grams

Going back to the preceding menu without clicking on the Turn&Push button (11) will not save the new value.

Likewise, after a period of inactivity of 10s without validation, the appliance exits the "Menus" mode and automatically returns to the home screen, without saving the value.

ACCESS TO THE MENUS

A long press on the Turn&Push button (11) activates the "Menus" mode

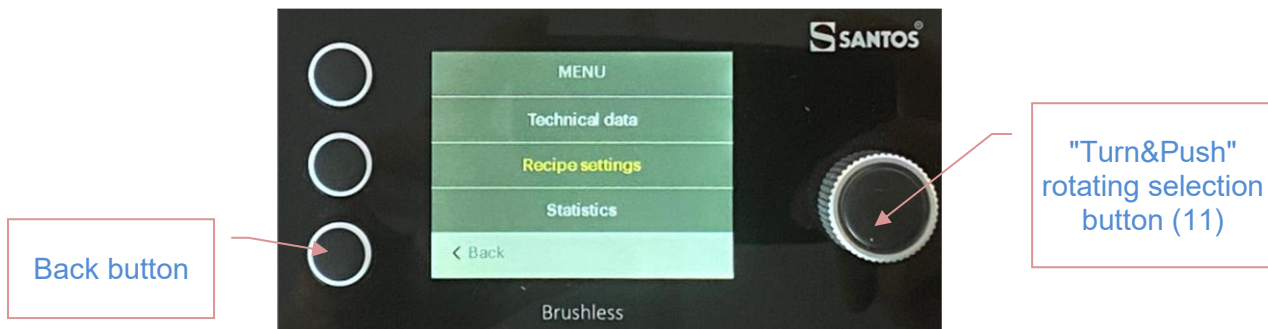

Use the rotating Turn&Push button (11) to scroll through the menus and select them

Menu list

Recipe settings

- ↵ Recipe creation
 - Recipes 1 to 6
- ↵ Recipe activation
- ↵ Portafilter detection(67GBW)
- ↵ Portafilter settings(67GBW)

Display

- ↵ Dose counters
 - Total/Partial
- ↵ Brightness
- ↵ Standby time
- ↵ Prolonged Standby time

Settings

- ↵ Recipes
 - Quick modification
 - Recipe reset

- Stop&Go management (67)
- ↵ GbW settings(67GBW)
 - Calibration
 - Calibration verification
 - Balance (deactivation)
- ↵ Burrs
 - Burrs wear indicator
 - Burrs history
 - Burrs change
- ↵ Statistics
 - Total counter
 - Partial counter
 - Reset the partial counter
- ↵ Event log
- ↵ Software version
- ↵ Time / Languages

Displaying the dispensed dose counters

The display of the "Total" and "Partial" counters is activated separately.

Note: The Total counter cannot be reset.

Recipe creation

The appliance has 6 recipes that can be configured.

- Pictogram, timer, motor speed.

The "Hand" pictogram corresponds to the "Pulse" function: no timer/weight setting. The "Pulse" function can operate for a maximum of 1 minute.

"Pulse" function

The "Pulse" function can operate for a maximum of 1 minute

- 67 version -

The Pulse recipe operates by pressing and holding the cycle start button

- 67GBW version -

Select the "Pulse" recipe

Place the portafilter on the balance, then release the portafilter.

Press and hold the selection button on the control panel associated with the Pulse recipe.

"Deactivated balance" mode: Select the "Pulse" recipe, then press the Pulse recipe selection button

Recipe activation

This menu allows you to activate the display of recipes on the home screen.

By default, only recipes 1, 2 and 3 are activated.

At least one recipe has to be selected.

"Stop&Go" management (67 version)

This menu allows you to activate "Stop&Go" and to select the pause time.

"Stop&Go" function: in this mode, you must press and hold the "start" button (18), until the timer has elapsed, in order to deliver the dose. The motor stops and pauses when the portafilter is removed. The timer continues when the portafilter is returned, except if the time between the 2 maintained presses is greater than the set pause time.

The pause time can be set from 1 to 10 seconds.

Quick modification of recipes

Menu allowing you to authorise or deny access to modify the active recipe, by double-clicking on the Turn&Push button (11).

Management of burrs wear and history of the number of sets replaced

Set of menus that allow you to check the wear indicator of the burrs set, record the replacing of a burrs set and to consult the appliance's history.

A wear indicator for the burrs  is displayed starting from 95% wear.

The indicator is erased once replacing the burrs set has been confirmed.

Event log

Lists the main events in the life of the appliance such as: the number of burrs set replacements with the rate of wear, incident history (overloads, overheating, blocking, etc.)

SETTING THE APPLIANCE

Step 1: Grind setting



CAUTION: Modifying the grind setting always entails adjusting the recipe timer setting (- *Version 67 only* -).

Note: Never operate the appliance with the two burrs in contact. Putting the burrs in contact can cause the grind to jam in the grinding body and premature wear of the burrs.

The appliance is factory set so that the "0" mark on the graduated plate of the nut (24) corresponds to the finest grind without the burrs touching each other (fig. A).

The appliance is delivered with the grind set to the espresso type, **about mark 12** on the adjustment nut (24).

1. Pull the indexing lever (23) to unlock the adjustment nut (24).
2. Tighten the adjustment nut (24) clockwise (right-handed thread) one or two notches for finer grinding.
3. Loosen the adjustment nut (24) anticlockwise (right-handed thread) one or two notches for coarser grinding.
4. Release the indexing lever (23) to lock the nut (24).
5. Deliver 1 to 2 doses of coffee to check the grind setting.

The appliance can obtain a very fine grind. You must however make sure, according to the type of coffee used, that the burrs do not come into contact.

Step 2: Choosing the speed of the motor

- 67 version -

For each recipe, the speed of the motor can be chosen from 1 to 100% of the speed range of the motor.

The flow is linked to the choice of the speed. Always adjust the operating time after having modified the motor speed.

- 67GBW version –

For each recipe, the speed of the motor can be chosen from 10 to 100% of the speed range of the motor.

Step 3: Setting the dose of ground coffee (timers / weight)



IMPORTANT: Verify or adjust the grind setting before setting the timer of each recipe.

Clean the ground coffee outlet conduit (13) on a regular basis to prevent blocks of coffee agglomerated on the walls from disturbing the regularity of the dosing of the coffee. (fig. A)

- 67 version -

Adjust the value of the timers to obtain the quantity of coffee sought

- 67GBW version -

For each recipe, select the value of the weight sought

Note:

For each recipe, the appliance, at each dose, adapts the dosing settings to be close to the selected weight.

At each dose, the coffee grinder tares the portafilter and distributes the coffee weight independently from the weight of the portafilter.

FUNCTION SPECIFIC TO THE 67GBW

Portafilter recognition

Calibrate or check the calibration of the balance before activating this function (see "Calibration / Verification" chapter)

This function is configured in 3 steps:

1. Activate the function
2. Portafilter calibration
3. Associating Portafilter / Recipe

Step 1: Activate the function

- ↪ Go to the "Recipe settings" menu,
- ↪ Then in the "Portafilter detection" menu,
- ↪ Select "Enabled" then confirm by pressing the Turn&Push button (11)

Step 2: Portafilter calibration

- ↪ Go to the "Portafilter settings" menu
- ↪ Select the Portafilter to calibrate:
 - Place the portafilter on the balance
 - Then release it (wait for the balance to stabilise)
 - Press the Turn&Push button (11) to start the calibration
 - Exit the menu to select another portafilter
- ↪ Select another portafilter to weigh....

Caution! it is not possible to calibrate the same portafilter several times or a portafilter of which the weight is close to the weight of a portafilter that has already been saved (+ or – 10g).

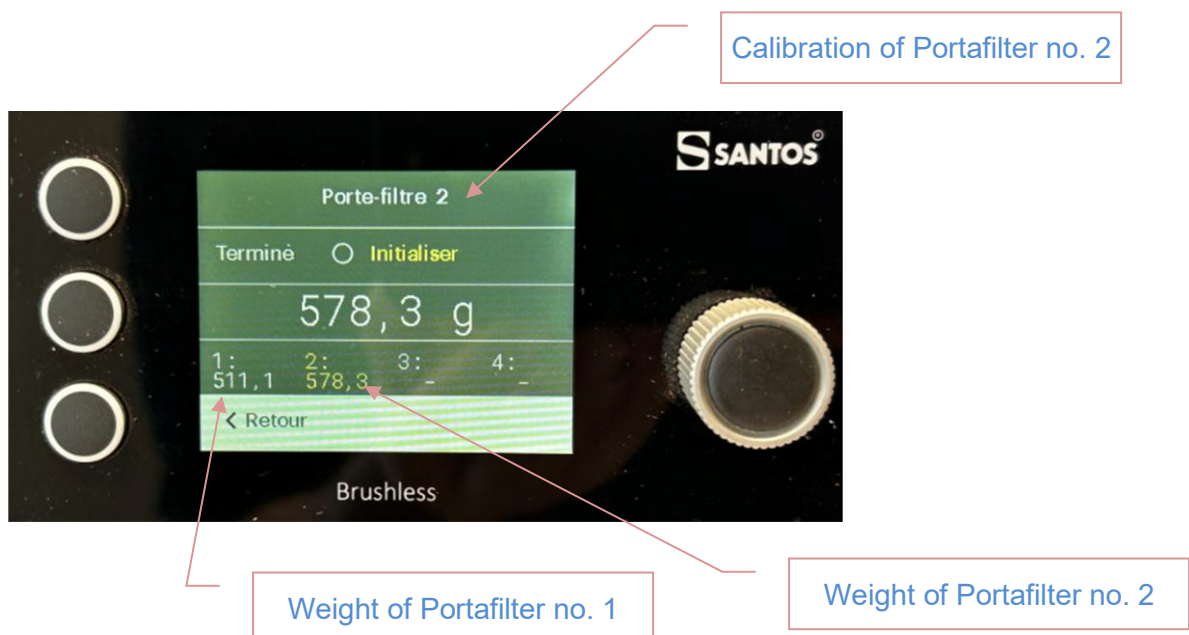

Step 3: Associating Portafilters and recipes

- ↵ Go to the "GbW recipe settings" menu
- ↵ Then in the "Recipe creation" menu
- ↵ Select the recipe to modify
- ↵ Turn the Turn&Push button (11) to display the "Portafilter" field
- ↵ Press the associated button to modify the field and be able to select one of the weighed Portafilters that has not yet been assigned to a recipe

Repeat the operation for all recipes that must be associated with a portafilter.

"Recipe creation" screen:

e.g.: Assigning Portafilter no. 1 to recipe no. 1

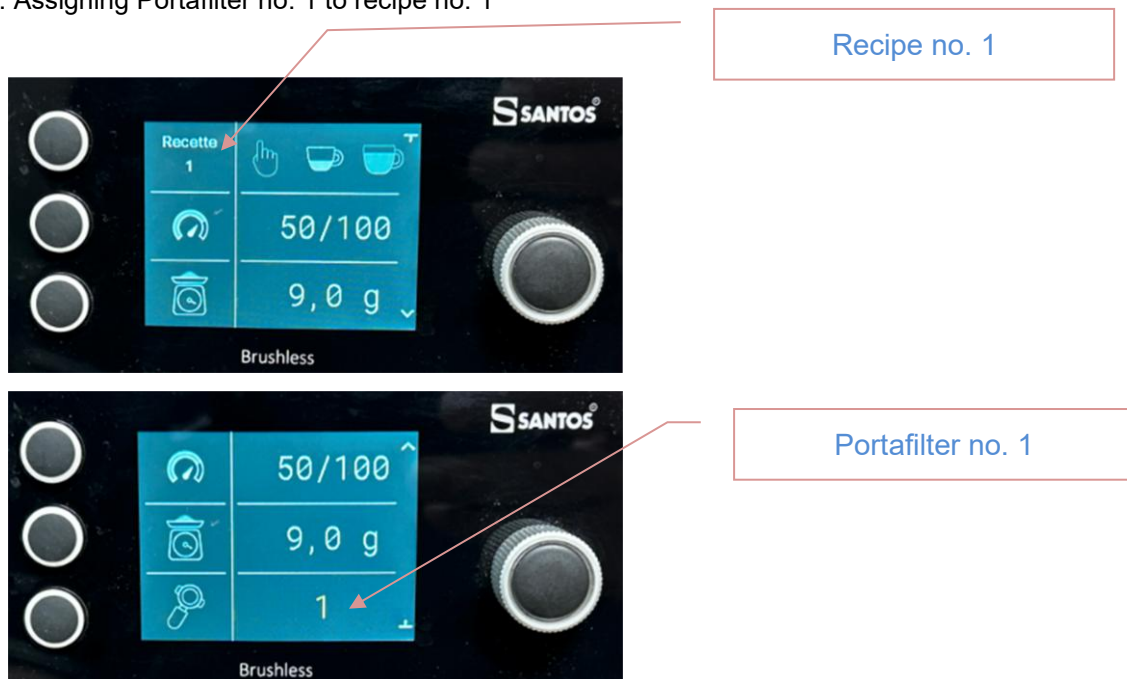

Home screen: the "Portafilter" logo indicates that the Portafilter recognition function is active and the number of the portafilter associated with the active recipe.

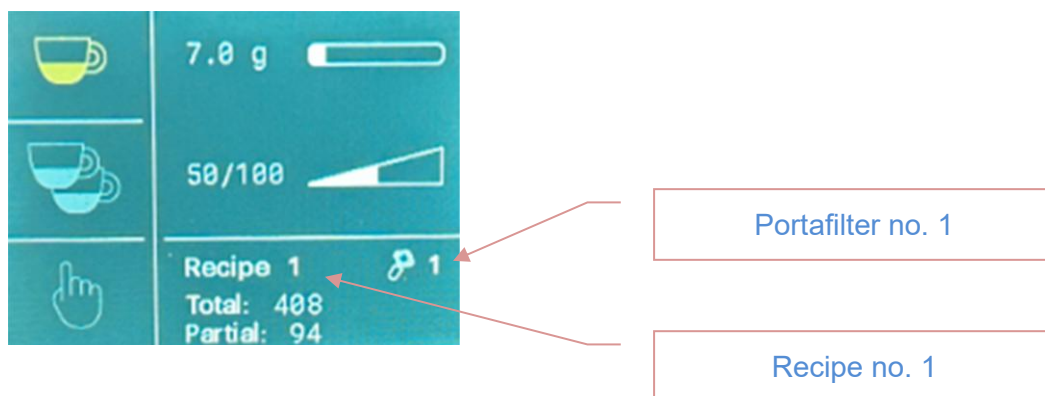

Note: only recipes associated with a portafilter will appear on the main screen (except for the "Pulse" recipe which is always active).

Deleting the calibration of a portafilter

The weight record for a portafilter can be deleted

- ↵ Go to the "Portafilter settings" menu
- ↵ Select the Portafilter to delete:
 - Press the Turn&Push button (**11**) to erase its record

Caution! deleting the portafilter deactivates the recipe that it is associated with.

It is therefore necessary to associate another portafilter in the "Recipe creation" menu or to weigh/calibrate another portafilter instead of the preceding one that was deleted.

Deactivating the "Portafilter recognition" function

Deactivating the function does not delete Portafilter calibration or the recipe/Portafilter associations.

- ↵ Go to the "Recipe settings" menu,
- ↵ Then in the "Portafilter detection" menu,
- ↵ Select "Deactivated" then confirm by pressing the Turn&Push button (**11**)

Deactivating the balance

(Deletion of dosing management by weight and return to operation with dosing by Timer)

- ↵ In the "Settings" menu,
- ↵ Then in the "GbW settings" menu,
- ↵ Select the "Balance" menu
- ↵ Select "Deactivation"
- ↵ Click on the Turn&Push button (**11**) to confirm

Operation of the 67GBW in Timer mode

Use the Turn&Push button (**11**) or the selection buttons to select the desired recipe
Press the already-selected button to start the recipe

Calibration / Calibration verification of the Balance

- ↵ Go to the "GbW settings" menu,
- ↵ Then in the "Calibration" menu
 - Check that the balance is clean
- ↵ Click on the Turn&Push button (**11**) to confirm the weight of the empty balance
- ↵ Select the value of the reference weight (about 500g) (e.g.: 2-spout Portafilter weighed on a Barista balance)
- ↵ Place the reference weight and click on the Turn&Push button (**11**) to confirm,
- ↵ Click again to switch to "Verification" mode

STANDBY

The appliance has 2 standby modes and an automatic stop mode that reduce power consumption.



After inactivity that can be set from 1 to 60 minutes, the appliance goes into standby for 1 hour. The display is dimmed automatically.

Prolonged standby turns off the screen. A LED blinks intermittently.

The prolonged standby time can be set from 0 to 8h. The appliance turns off automatically after the prolonged standby time.

Note: The value of "0" allows the appliance to be turned off after 1 hour on standby.

CLEANING

IMPORTANT!



- In all cases, unplug the appliance power cord (7).
- The appliance must not be cleaned with a water jet or water under pressure.
- The appliance must not be washed in the dishwasher.

Cleaning the Bean hopper

Clean the bean hopper (2) with a soft cloth or with a non-abrasive sponge and standard household washing-up liquid.

Cleaning the GbW Balance

Clean the GbW balance (36) regularly using a soft cloth or a slightly damp, non-abrasive sponge, while taking care not to damage the cable.

Check that the feet of the coffee grinder are properly in place between the openings of the Foot guide (37) de la balance. The balance must be able to be freely moved a few millimetres to the right and left and up and down.

Quick access to the grinding body and anti-static tab

The appliance has a quick access system to the grinding body without modifying the grind settings in order to facilitate cleaning the grinding body, burrs and the anti-static tab.

- Close the shutter of the bean hopper (2).
- Empty the coffee beans from the grinding body (25), with the "Pulse" button or by distributing several doses.
- Remove the bean hopper (2).
- Unscrew 2 turns the 3 grinding body closing screws (22) (Fig. D).
- Without touching the indexing lever (23), slightly turn and lift the adjustment nut (24) to access the inside of the grinding body.

Reassembly:

- Place the upper body (21) back in the lower body (25) making sure to properly align the parts so that they do not become stuck. Do not force.
- Position the upper body abutting against the locking slots (anticlockwise rotation).
- Tighten the 3 retaining screws (22).

Cleaning the grinding body

Regularly clean the grinding body (25) with a brush (see chapter: "Quick access to the grinding body").

Cleaning of the anti-static tab

Clean the anti-static tab (34) and if necessary, replace it (34) (see chapter: "Quick access to the grinding body").

Cleaning the coffee outlet conduit

Clean the coffee outlet conduit (13) regularly with a brush. Do not insert any aggressive object (see chapter: "Quick access to the grinding body").

SAFETY**Bean hopper safety**

The appliance cannot start if the bean hopper (2) is not correctly positioned on the appliance.

SERVICING

Before working on the appliance, it is essential to disconnect it from the mains (7).

Spare parts

This machine does not require any particular maintenance. The bearings are lubricated for life.

If it is necessary to replace wear parts such as burrs, electrical components or other parts, refer to the parts list (see exploded view at the end of this manual).

When **ordering spare parts** (for part numbers see the exploded view at the end of this manual), specify:

- **the type,**
- **the serial number of the appliance and**
- **the electrical specifications (6)**

marked on the bottom of the appliance.

Access to the inside of the appliance

Before working on the appliance, it is essential to disconnect it from the mains (7).

Opening of the side cover (19): use the 2 keys 67005 (33) provided with the appliance.

- Insert the 2 keys (33) in the kerfs (32) of the Left side cover
- Gently pull the 2 keys to unclip the cover.

Replacing burrs



IMPORTANT! always replace the 2 burrs (27) at the same time.

Use only **SANTOS** burrs

Refer to the table of the appliance's specifications to order the reference for the burrs set that corresponds to your appliance.

The 2 burrs are identical and can be mounted on the movable plate (26) (movable burr) or on the adjustment nut (24) (fixed burr) (fig. E).

1. Close the bean shutter (3) (fig. A).
2. Turn on the appliance, draw several doses to empty the grinding body.
3. Turn off the appliance and disconnect the power cord (7).
4. Remove the bean hopper (2).
5. Loosen the adjustment nut of the burrs (24) one half turn (anticlockwise direction).
6. Unlock and unscrew **2 turns** the 3 locking screws (22) of the upper grinding body (fig. D).
7. Remove the upper portion of the grinding body (21).
8. Unscrew the 3 screws from each burr (fig. E). Note: To lock the rotation of the burr support plate (26) when unscrewing or screwing the fastening screws of the movable burr, place a non-aggressive screwdriver between the grinding body and one of the fins of the plate.



CAUTION! Do not insert the screwdriver into the orifice of the coffee outlet conduit. *This would destroy the anti-static tab and interfere with the proper functioning of the appliance.*

9. Perfectly clean the entire grinding body and in particular the burrs supports.
10. Place each burr on its support, making sure that there is no coffee dust between the burr and its support.



CAUTION! *The slightest small coffee particle placed under the burr can interfere with the proper operation of the appliance. We recommend cleaning the grinding body assembly with a compressed air jet or a dry brush.*

CAUTION! *do not unscrew the fastening shaft (30) from the burr support plate (26) in order to avoid damaging the geometry of the whole (fig. E).*

11. Once the 2 burrs are replaced, place the upper body (21) back in the lower body (25) making sure to properly align the parts so that they do not become stuck. Do not force.
12. Position the upper body abutting against the locking slots (anticlockwise rotation).
13. Tighten the 3 retaining screws (22).
14. Without forcing, screw the adjustment nut (24) of the burrs until the 2 burrs come into contact (fig. D).
15. Unscrew the adjustment nut (24) about ten notches to release the burrs that are in contact.

16. Connect the appliance and turn it on without coffee. Screw the adjustment nut (**24**) until the 2 burrs come **slightly** into contact (slight noise).
17. Turn off the appliance.
18. Unscrew the fastening screws on the graduated plate (**29**) and re-index the "0" of the graduated plate (**28**) with the indexing mark (**35**).
19. Screw back the fastening screws of the graduated plate (**29**).
20. Unscrew the adjustment nut (**24**) from 10 to 15 notches.
21. With coffee, adjust the grind (see the "**Grind setting**" part).
22. Then adjust the timers if the new burrs have modified the flow of the appliance (see the "**Setting the dose of ground coffee**" part).

Resetting the wear percentage of the burrs

Validate the replacing of the burrs set in the "**Technical info / Burrs change**" menu

Prolonged non-use

This appliance has no restrictions to prolonged inactivity.

We simply recommend cleaning it before use and checking the condition of the components of the appliance (e.g. power cord, seals and other spare parts). If the appliance will not be used for more than 1 month, it is recommended to vacuum out any coffee residue in the grinding body in order to prevent the risk of fouling by clumping and hardening.

TROUBLESHOOTING ASSISTANCE

It is necessary to identify what has caused the appliance to stop working. In any case, if the problem persists, switch off (unplug the power cord (7)) and call in maintenance service or contact an approved SANTOS dealer.

If necessary, remember to close the shutter (3) of the bean hopper before removing the hopper.

The appliance is not in the correct language

- Press the up and down selection buttons (10) simultaneously for 5 seconds for direct access to the "choice of language" menu.

The appliance does not start

Screen (9) off:

- Press one of the selection buttons (10).
- Press the On/Off button (12).
- Press the overcurrent protector reset button (20) (check the condition of the fuse) then press the On/Off button (12).
- Check: the mains supply, the condition of the power cord (7).
- Unplug the power cord (7) for 30 seconds then plug it back in and press the On/Off button (12).
- If the appliance has been working for a long time, wait 30 minutes. The motor is protected by a built-in thermal protector. In case of overheating, the motor stops and cuts off power to the electronic board.
- Contact the maintenance service or a person authorised for electric shock risks to test the components inside the appliance.

Screen (9) on:

- Check for the presence of the hopper (2)
- Turn off the appliance and wait 30s before turning it on again.
- **67 version:** Press the portafilter flap (18)
- **67 version:** Check that the portafilter correctly moves the portafilter flap (18), you should hear a little "click".
- **67GBW version:** Check for the absence of any object in contact with the balance
- **67GBW version:** Release the portafilter once it is placed on the Balance.
- **67GBW version:** Check the stability of the balance or of the work surface on which the coffee grinder is placed and the absence of any draft directed towards the balance
- **67GBW version:** Check that the correct portafilters are used in "Portafilter recognition" mode
- **67GBW version:** Check the calibration of the balance
- Check that the burrs (27) are not in contact and prevent the motor from starting.
- Check that there are no foreign objects caught between the burrs.
- Contact the maintenance service

The appliance stops because the motor has overheated: (the motor unit is hot)

The motor is protected by a thermal protector. The appliance stops if the motor overheats.

- Wait for the motor to cool down (20 to 45 minutes), then press the On/Off button (12).

The appliance stops following an overload

A foreign body between the burrs, the burrs in contact, can cause motor overload.

In these conditions, either the thermal protector or the overcurrent protector (fuse) can be activated and stop appliance operation.

If the appliance is hot, then see the "The appliance stops because the motor has overheated" part.

Otherwise:

- Turn off the appliance (unplug the mains plug (7))
- At the rear of the appliance (fig. C), push the button (20) to reset the overcurrent protector. If the button does not remain in the "reset" position, allow the appliance to cool before renewing the operation.

If the problem persists, switch off the power (unplug the mains plug (7)) and call in maintenance service or contact a Santos authorised dealer.

The dose of ground coffee is not even

- Check that there are coffee beans in the bean hopper. We recommend having at least 100 g of coffee beans in the hopper.
- Clean the ground coffee outlet conduit (13). (fig. A)
- Replace the anti-static tab (34)

The appliance runs without filling the portafilter

- Check that there are coffee beans in the bean hopper.
- Check that the bean hopper shutter (3) is in the open position.
- Clean the grinding body, tab and the coffee outlet conduit.
- Try to set a coarser grind
- Replace the burrs (27).

- 67 version - Espresso coffees tend to be increasingly lighter

- Check and adjust the grind setting then
- Check and adjust the timer settings. It is normal to adjust the duration of the timer with the wear of the burrs or a change in the type of roasted coffee.
- Replace the burrs (27) if the timer times become excessive.

- 67GBW version - The grinder does not stop

- Do not touch or hold the Portafilter while the dose is being distributed.

- 67GBW version - The dose displayed is different from the actual dose

- Check the calibration of the balance.

- 67GBW version - The Balance is defective

- You can simply replace and connect another SANTOS balance.
- Or deactivate the Balance and use the appliance in TIMER mode

The appliance is not operating after a power failure

- The appliance is equipped with a "No voltage" safety. Restart the appliance by pressing the On/Off button (12).

The appliance turns off automatically

- To reduce power consumption, the appliance has an adjustable standby system and an automatic stop.
- Restart the appliance by pressing the On/Off button (12).

The burrs set replacement indicator remains visible

- Validate the replacing of the burrs set in the associated menu. 

TECHNICAL SPECIFICATIONS OF THE APPLIANCE

TECHNICAL SPECIFICATIONS

Model		67 / 67GBW
Use:		Roasted coffee beans
Power voltage	(V)	100-240 ~
Frequency	(Hz)	50/60
Motor:		
Absorbed power:	(W)	1010
Diameter of the burrs	(mm)	63.5
SANTOS burrs reference		00001B
Bean hopper capacity	(kg)	1.1
Number of recipes that can be configured		6
Grind setting range		Very fine to coarse
Flow (4)	(kg/h)	5 to 50
Time-delay fuse 5 x 20		8A T
Intermittent operation (3)		10 seconds on and 20 seconds off
Dimensions: Height	(mm)	520
Width	(mm)	226
Depth	(mm)	362
Weight: Net weight	(kg)	11.5
Shipping weight	(kg)	13
Noise level: (2)	(dBA)	65

(1) These values are given for information only. The exact electrical characteristics of your appliance are noted on its manufacturer's plate.

(2) Noise level measured at sound pressure with appliance under load at 1 m from its axis according to EN 31201.

(3) Cycle 10sec ON / 20sec OFF:

This professional appliance is intended for intermittent use with a 10-second "on" and 20-second "off" cycle.

This cycle corresponds to the "on" time to perform the function and the "off" time for the preparation and service of the processed products, in accordance with the requirements of the standard:

EN 60335-2-64+A1:2004 Part 2-64: Particular requirements for commercial electric kitchen machines.

(4) Flow: the flow depends on the type of beans used, the grind setting and the choice of the motor speed.

Electrical diagram

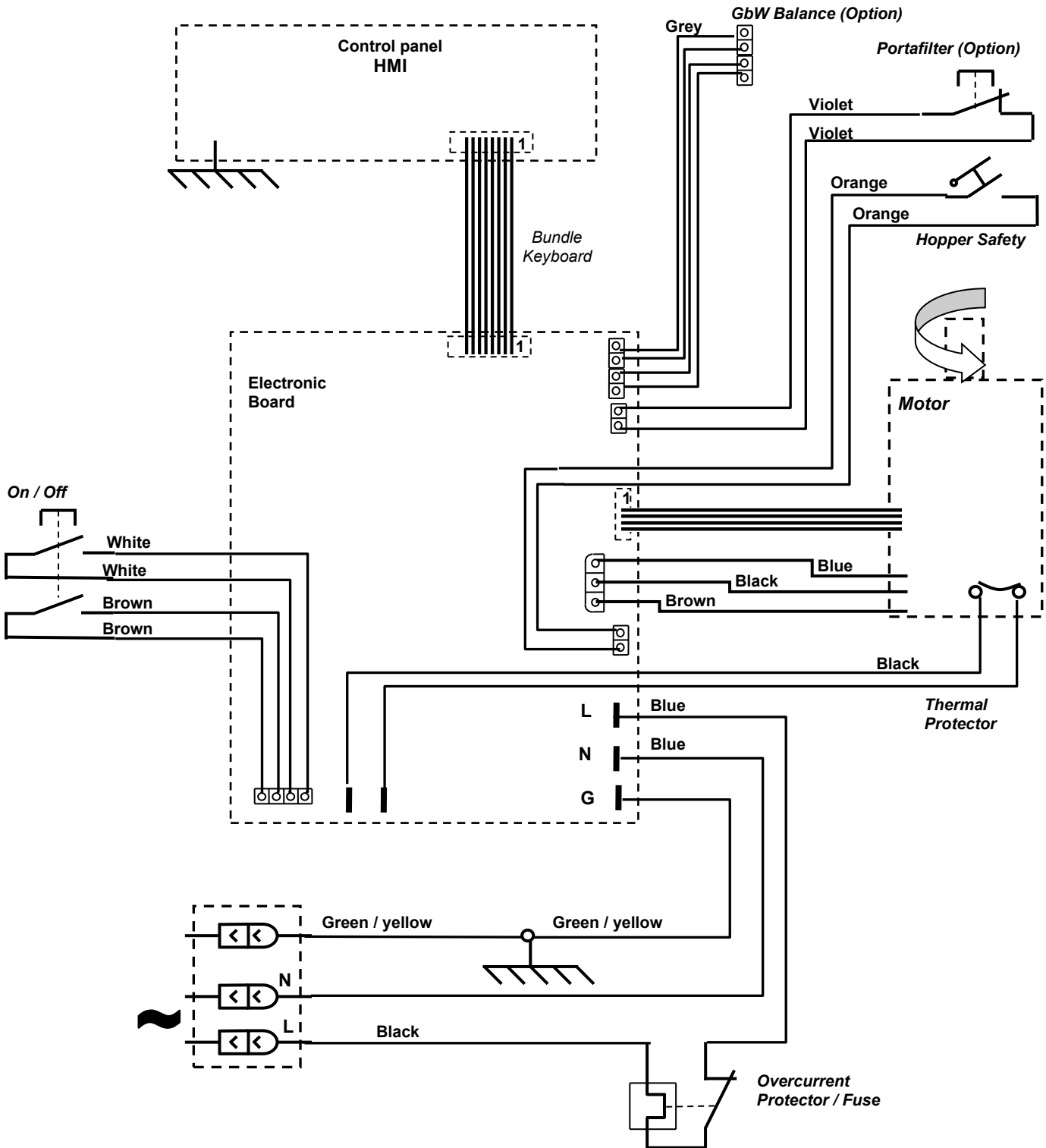

Correlation table

ITEM	Designation
1	Bean hopper cover
2	Bean hopper
3	Bean hopper shutter
4	Grounds collector
5	Power cord connection case
6	Manufacturer's plate
7	Power cord.
8	Control panel
9	Screen
10	Selection buttons
11	Turn&Push button
12	On/Standby button
13	Ground coffee outlet
14	Ground coffee outlet retaining screw
15	Portafilter fork
16	Fork retaining screw
17	Grinding body
18	Portafilter detection flap
19	Base plate
20	Overcurrent protector
21	Upper Portion of the grinding body
22	Grinding body locking screw
23	Indexing lever
24	Grind setting nut
25	Lower body
26	Burr support plate
27	Burr
28	Graduated plate
29	Graduated plate locking screw
30	Motor shaft nut
31	Portafilter support
32	Cover dismantling key opening
33	Cover dismantling key
34	Anti-static tab
35	Indexing mark
36	Precision balance
37	Foot guide
38	Balance cable

Fig. A



Fig. B

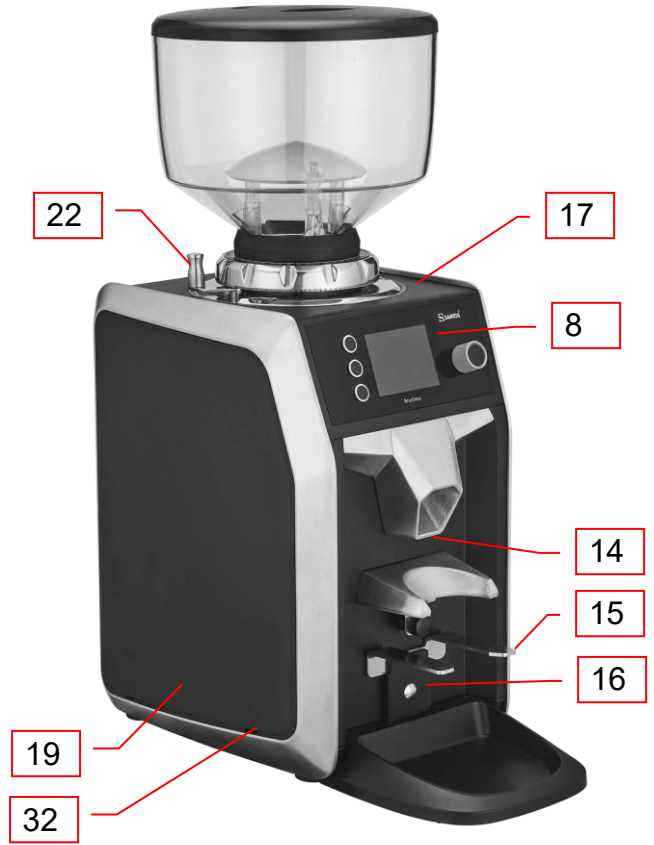

Fig. D

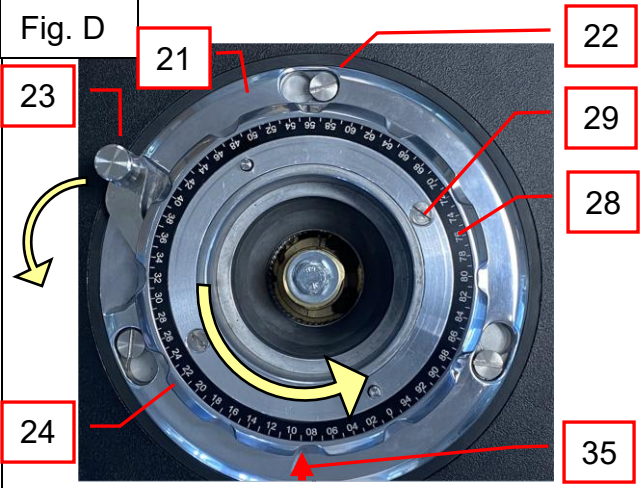

Fig. E

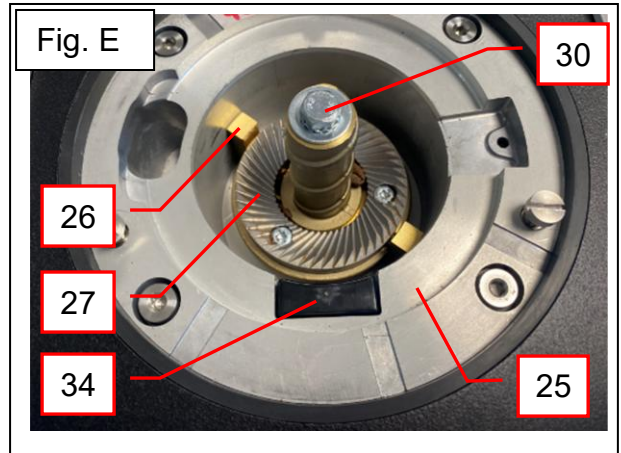
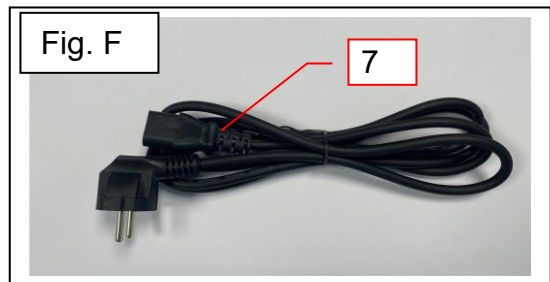
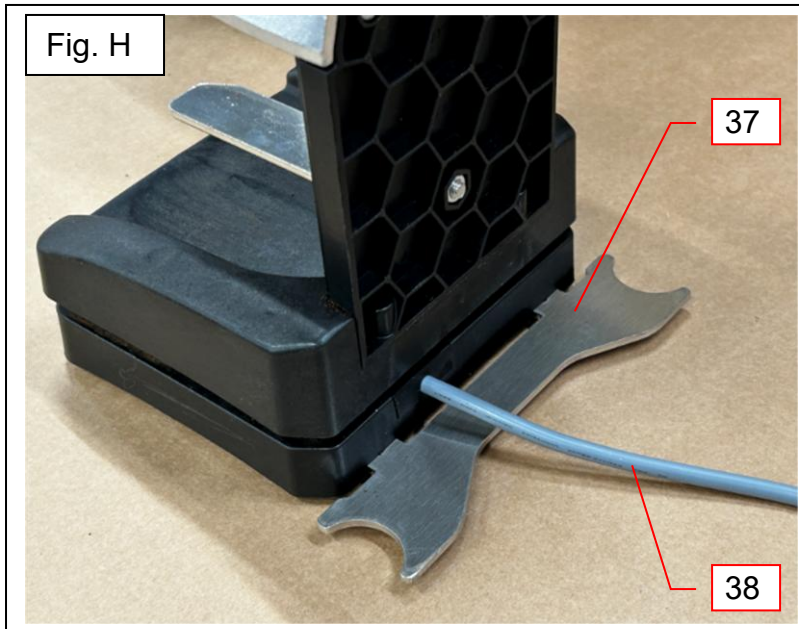
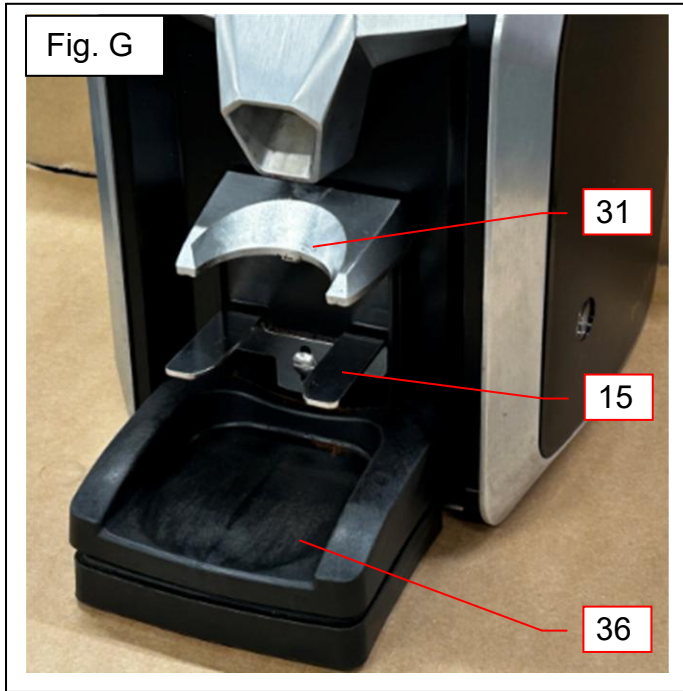

Fig. C



Fig. F





WARRANTY CERTIFICATE

WARRANTY

Since 01.01.95, all are appliances **comply with the EC standards and bear the CE label**. Our warranty is for **twenty-four months** from the date of manufacture shown on the identification plate except for asynchronous motors (made up of a rotor and a stator) which are guaranteed for 5 years from the date of manufacture. The warranty is strictly limited to the free replacement of any original part acknowledged by us as being defective as a result of a fault or a manufacturing defect and identified as belonging to the appliance in question. It does not apply to damage resulting from an installation or use which does not comply with the instructions supplied with each appliance (user manual) or in the event of an obvious lack of maintenance or non-observance of basic electrical safety rules. The warranty does not apply to normal wear. All part replacements under warranty are made after return of the defective part to our workshop's carriage paid, accompanied by a **copy of the Compliance Declaration** on which the serial number of the appliance is shown. All appliances have a CE compliant **identification plate**, a copy of which is shown in the Compliance Declaration (serial n°, date of manufacture, electrical specifications, etc). In the event of serious damage which is deemed only to be repairable in our workshops, and **after agreement from our services**, all appliances under warranty are to be dispatched by the Distributor carriage paid. If the appliance is repaired or repackaged outside the warranty, the forwarding and return transport is the responsibility of the Distributor. Parts and labor are invoiced at the prices in force (spare parts price - hourly labor cost). A prior estimate can be provided.

Coffee grinders without original SANTOS grinding-discs are not covered by the warranty. The warranty, repair and repackaging conditions of espresso coffee grinders are covered by special instructions. Our warranty does not include payment of penalties, making good of direct or indirect damage and in particular shortfall in earnings resulting from the non-compliance or defect of products as SANTOS's global responsibility is limited to the sales price of the product supplied and the repair of defective products, if any.

In the event where a defect is revealed during the warranty period, the Distributor must, unless otherwise agreed in writing by SANTOS, inform its customer to discontinue any use of the defective product. Such use would waive SANTOS of any responsibility.

APPLIANCE IDENTIFICATION PLATE

For all documents not supplied with
the appliance.

Printed and Downloaded