



www.santos.fr



- Contains and dispenses ground coffee, for all espresso machines, adjustable dose from 5,5 to 9,5 g.
- Easily removable dispenser can be hold on the two bases : tabletop or wall-mounted.
- The perfect container for serving different types of coffee or decaffeinated.
- Different colours : black, brown, grey...
- Removable dispenser for easy cleaning and maintenance.

Precision Coffee Dispenser

- tabletop #56
- wall-mounted #57

Bars, coffee shops or coffee roasters...

- A basic appliance to diversify your coffee menu.
- Save time and make good decaffeinated or specific coffees...



Removable sticker holder



Coffee tamper



TABLETOP #56



WALL-MOUNTED #57

The dispenser can be hold on the 2 bases in one simple push.



Internationally patented models.

Technical specifications

Ground coffee capacity : 250 g

Tabletop #56

Weight Net 6 Kg (22 lbs)
Packed 7 Kg (24 lbs)

Dimensions **Appliance**
Heigh 396 mm (16")
Width 168 mm (7")
depth 280 mm (11")

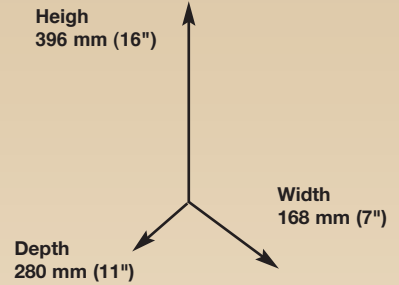

Wall-mounted #57

Weight Net 7 Kg (22 lbs)
Packed 8 Kg (24 lbs)

Dimensions **Appliance**
Heigh 473 mm (19")
Width 168 mm (7")
Depth 250 mm (10")

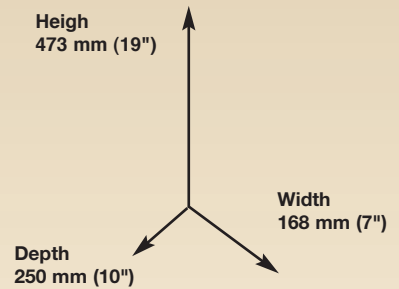

Safety - Regulation - Hygiene

This appliance has been designed to comply with the most strict international safety and hygiene regulations in conformity with the standards, especially :

Harmonized European standards
EN 292-1 and 2

